

SELLA II SEALER INSTRUCTION MANUAL

PURPOSE

This product is intended for sealing envelopes for steam sterilization. Follow strictly the instructions and orientations from the manufacturer of your packages regarding their appropriate usage, cautions, conservation and storage.



USER INSTRUCTIONS

- 1▶ Undoing three detachable screws on both sides, place the support on sealer.
- 2▶ Connect the power cord to the power connector which is on the left side of the sealer, check if the voltage of your equipment matches the voltage of the local electrical network.
- 3▶ Switch the sealer on by using the power switch on its left side. When the green LED goes on (after around 3~5 minutes) the sealer will be ready to be used.
- 4▶ Place the roll on the holder. The beginning of the roll shall be inserted through the back side, between the pressure bar and the sealing bar always with the paper side down (resistance's side) and the plastic side up (directly under the upper pressure bar). Pull the sealer arm forward or backward until locked.

Note: Exaggerated pressure may break the sealer arm and this kind of damage is not covered by the warranty.

- 5▶ When the green LED turn to red the sealing will be completed. Slide the blade to cut the envelope, raise the sealer arm and remove the package.

Note: If the blade knob is pulled slowly the paper may crease and the cutting will not be adequate. To make it more precise, pull the blade knob quickly. If necessary, slide the cutting blade more than once.

GRAPHIC REFERENCE

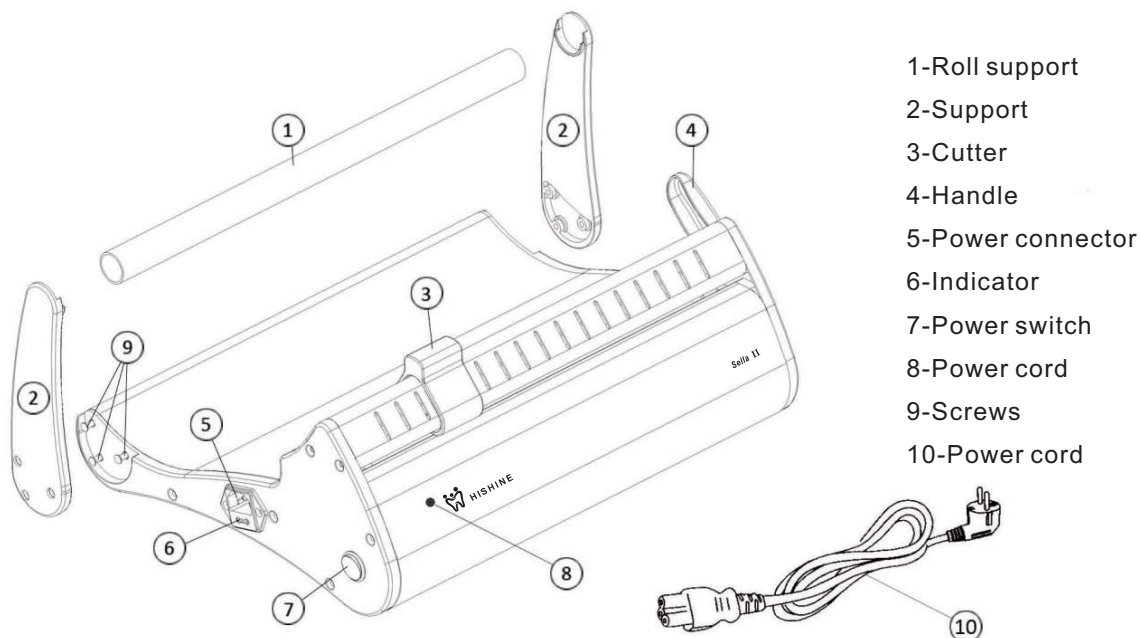

NOTES

- 1▶ Keep the sealing platform always clean. The accumulation of waste on the sealing area will reduce the life cycle of the resistance and the insulating material. For an effective cleaning, wait for the sealing area to cool down and use a cloth slightly moistened with alcohol.
- 2▶ If it is necessary to replace the fuse, use only those which have the same specifications as the genuine parts.
- 3▶ While packing the instruments protect the ones which have cutting and piercing tips with cotton or gauze to avoid the packages rupture.
- 4▶ Place the sealed envelopes with instruments into the autoclave. Check the instructions from the manufacturer of your autoclave regarding the arrangement of the packages and the sterilization cycle.
- 5▶ Unplug the power cord when servicing or cleaning the equipment.